



GNY Wallet binding Tutorial

The instructions in this document will provide you with all the steps required to bind your Metamask wallet to your GNY wallet. This will allow you to benefit from the GNYi rewards program.

GNYi is a community-driven rewards system that factors in various positive actions taken by GNY token holders and provides them bonuses for continually acting in a positive manner. For example the holding of and/or addition of GNY ERC-20 tokens will result in rewards. These will be in the form of GNY Mainnet tokens automatically delivered to your bound GNY mainnet address following each GNYi rewards cycle calculation.

This tutorial covers the binding procedure in conjunction with the MetaMask software wallet through a Chrome browser extension: <https://metamask.io/>
Please note that the current GNY wallet is optimised for desktop viewing only.

Wallet binding

1. Login to your GNY wallet at <https://wallet.gny.io/#/login>
2. Select the "Ethereum Swapgate" option on the left hand menu

The screenshot shows the GNY Web Wallet interface. The top header displays "GNY Web Wallet" on the left and "Latest Block Height: 2095915" on the right. A left-hand navigation menu includes options: Home, Transfer, Delegates, Assets, Machine Learning, **Ethereum Swapgate** (highlighted with a red box), and BSC Swapgate. The main content area is divided into two sections. The top section, titled "Account Info", shows the "Address: G4M7QaXh2wvrviZKveY1ihkqz1wrD" and "Is Locked: No". Below this, the "Balance:" is indicated. The bottom section, titled "Set Second password", features a text input field labeled "+ 2nd P." and a blue button labeled "Set Second Passphrase".

3. On the next screen click the "Connect to Metamask" button.

The screenshot shows the GNY Web Wallet interface for connecting to a wallet. The top header displays "Latest Block Height: 1847938" on the left and "Current Network: Mainnet" on the right. The main content area is divided into two sections. The top section, titled "GNY Address", has an empty text input field. The bottom section, titled "Ethereum Address", has a text input field containing "ethereum address". Below the input fields, there are four blue buttons arranged vertically: "1. Connect to metamask" (highlighted with a red box), "2. Bind", "3. Approve", and "4. Deposit".

4. Approve the connection between the GNY wallet and Metamask by clicking “Next” on the Metamask notification screen, and then click “Connect” on the follow up screen.

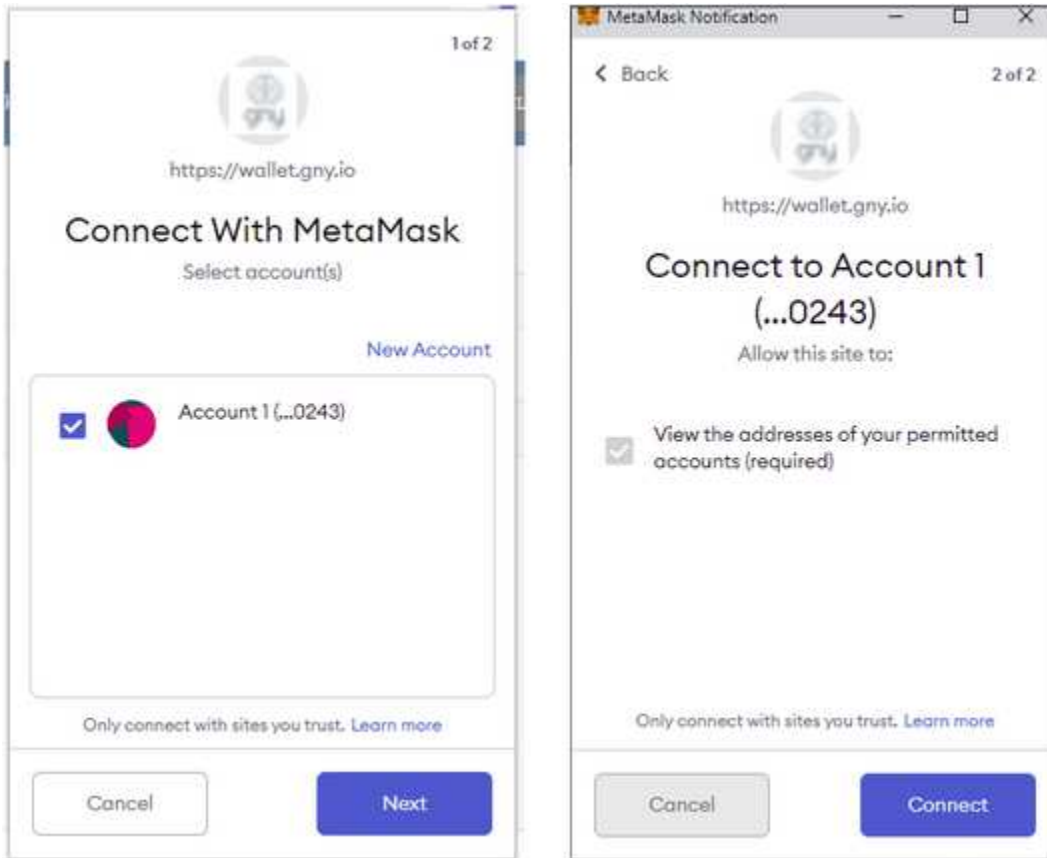

Once the GNY wallet and Metamask wallets are connected your Metamask’s ethereum address will populate in the GNY wallet

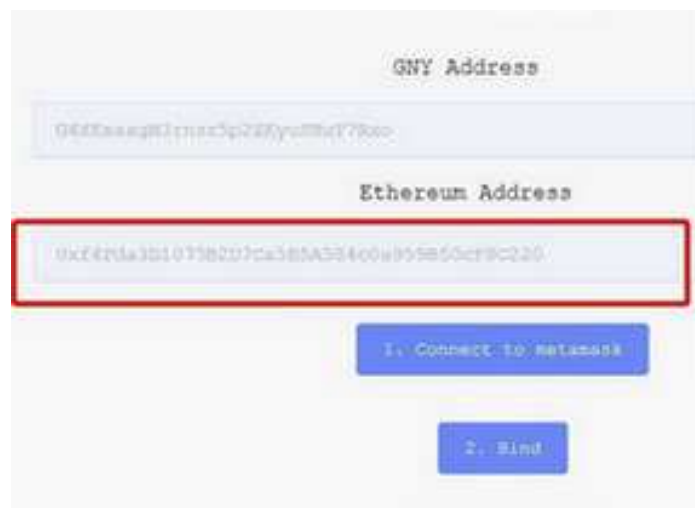

5. Proceed to the next step by clicking the second button labeled “Bind”.

GNV Address

G4M7QaXh2wvrvizKveYlihkgziwrD

Ethereum Address

0x47E365a4e995b6Cd9Ca8B64fBD37d409bD9a0243

1. Connect to metamask

2. Bind

3. Approve

4. Deposit

Metamask will ask you to confirm; click confirm if the fees are acceptable.

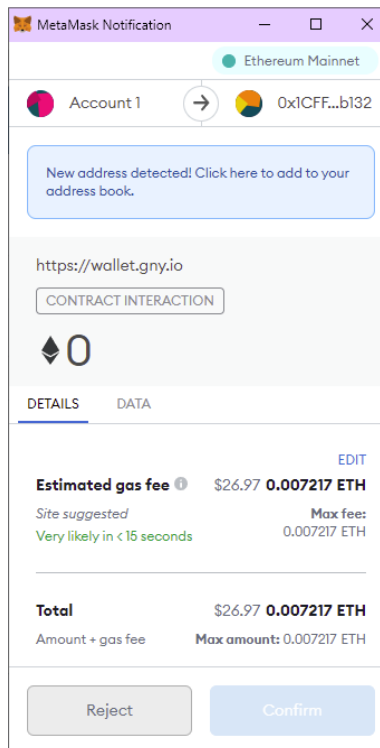

You have now completed the binding of your Metamask wallet to your GNY wallet.